



THE 23RD PHILIPPINE WORLD BUILDING AND CONSTRUCTION EXPOSITION



WORLD BEX

POST EVENT REPORT

ORGANIZED BY: **WORLD BEX SERVICES INTERNATIONAL**



INTRODUCTION

Leading at the forefront of innovation, the Philippine World building and Construction Expo or simply WORLDBEX continues to play a significant role in elevating the way we build and design our spaces. For its 23rd year, WORLDBEX once again demonstrated its capacity to deliver no less than a world-class trade experience for trade practitioners and enthusiasts alike.

Centering on the theme of “Shaping Innovations Toward Sustainability”, WORLDBEX 2018 sought to promote among the construction and design community a perspective that deems mindful innovation as a sustainable philosophy in their practices. Gathering a total of 505 local exhibitors and 270 international exhibitors from countries such as China, Malaysia, Korea, Singapore, Denmark, Spain, Indonesia, Thailand, New Zealand, and UAE, WORLDBEX 2018 was able to showcase close to 1,500 booths.

As a further testament of the show’s brimming success, this year’s WORLDBEX not only managed to attract close to 200,000 visitors but also, it noted a 25% increase in international exhibitors, a 12% increase in local exhibitors, and a 20% increase in the total number of booths. For WORLDBEX, this only marks the beginning of bigger things to come especially as it gears up to celebrate its Silver Anniversary.



SPONSORS



IN COOPERATION WITH



SUPPORTED BY



ASSOCIATION PARTNERS



SERVICE PROVIDERS



MEDIA PARTNERS



MESSAGES

2018

©WORLDBEX



My warmest to the organizers, participants and trade visitors of the 23rd Philippine World Building and Construction Exposition (WORLDBEX).

This exciting gathering coincides with the government's unprecedented infrastructure development program that aims to improve connectivity and create more opportunities for growth. By bringing together leading trade professionals from all over the world, this event highlights the industry's important role in our nation-building efforts.

May this year's WORLDBEX not only showcase the latest innovation and trends in the market, but also deepen the partnership between the public and private sectors boosting our economy and empowering our communities.

The government counts on our allies in the building and construction industry to ensure the successful implementation of our national agenda. Together, let us further create vital linkages in this field as we move forward to achieve lasting change.

I wish you a productive expo.

A handwritten signature in black ink, which appears to read "Rodrigo".

Rodrigo Roa Duterte
The President of the Philippines
Malacanang Palace Manila

SUPPORT MESSAGES

2018



©WORLD BEX

Each year, we are happy to say that we are growing bigger, better, and bolder than ever. A testament to this is how we have gone from merely conducting our shows at a single venue to now being held in the three mega venues of World Trade Center, Philippine Trade Training Center, and SMX Convention Center. Truly, I can say that WORLDBEX 2018 is the biggest construction exposition in the country!

But beyond all this, I am proud to present to you the great things that are in store for all of you as we return for our 23rd year. As you might already know, this year's theme is "Shaping Innovations Toward Sustainability". This theme was born out of our goal to unite the construction and design industry to not only think outside the box but likewise become prepared and equipped to cope with the changes of our times.

Moreover, as we are likewise gearing up for our silver anniversary, we ultimately seek to inspire all of you to join us in considering what needs to be done to improve traditional perspectives. And thus open up the industry to more forward-thinking concepts that will bolster our industry to true progress.

Indeed, we are well on our way in transforming our industry for the better and we are happy to be on this journey with all of you. And so, without further ado, allow me to personally welcome all of you to the 23rd WORLDBEX!

Mr. Joseph L. Ang
Founding Chairman
Worldbex Services International

VISITOR STATISTICS

2018

©WORLDBEX



of the visitors were very satisfied with the quality of exhibitors' product profile

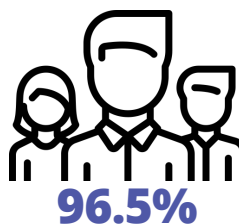

of the visitors would definitely recommend WORLDBEX to others



agreed WORLDBEX is the biggest & most attend construction & design show in the Philippines

183,000

TOTAL NUMBER OF VISITORS

TOP 5 VISITORS

- Architects (29%)
- Purchasers (20%)
- Engineer (16%)
- CEO/Presidents (13%)
- Distributor/Agent (10%)

TOP 5 INDUSTRIES

- Building/Civil Contractor (19%)
- Construction Service Provider (17%)
- Design Service Provider (14%)
- Distributorship (10%)
- Agent/Dealership (9%)

TOP 5 EVENT INTERESTS

- Architect's Gallery (35%)
- Interior Designer's Gallery (22%)
- City of Tomorrow (24%)
- Product Demos (11%)
- Projeto Manila (8%)

TOP 5 PURPOSES OF VISITING WORLDBEX

- Visit exhibitors and suppliers (34%)
- Updates on technologies (24%)
- Look for companies (17%)
- Gather information (13%)
- Source new products & services (12%)

TOP 5 PRODUCT INTERESTS

- Interior furniture and fixtures (35%)
- Flooring and Tiles (20%)
- Lighting (20%)
- Doors and Windows (12%)
- Concrete (12%)

EXHIBITOR STATISTICS



1,426

TOTAL NUMBER OF BOOTHS

775

TOTAL NUMBER OF EXHIBITORS

GROWTH STATISTICS

With all three venues combined, this year's WORLDBEX will encompass a total of 37,100sqm of show area as it showcases 1,500 booths by both domestic and foreign players of the construction sector.

In turn, WORLDBEX 2018 has noted a 25% increase in international exhibitors, a 12% increase in local exhibitors, and a 20% increase in total number of booths.



95%

of the exhibitors met their objectives in joining Worldbex 2018



98%

of the exhibitors felt that the event is highly successful

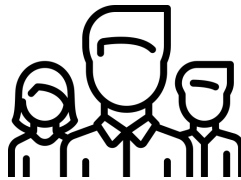

90%

of the exhibitors met their target market during the exhibit

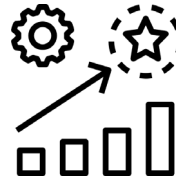

96%

of the exhibitors believe in the likelihood & post fair business



91%

believed that the business matching sessions provided excellent business leads & opportunities for their company

TOP 10 EXHIBING COUNTRIES

- China
- Malaysia
- Korea
- Singapore
- Denmark
- Spain
- Indonesia
- Thailand
- New Zealand
- UAE

TOP 5 EXHIBITOR PRODUCT LINES

- Building Materials, Equipment and Services (39%)
- Interior Design and Renovation (24%)
- Mechanical & Electrical Engineering Systems (10%)
- Information Technology and Telecommunication (9%)
- Exteriors (7%)

TOP 5 EXHIBING INDUSTRIES

- Manufacturer (22%)
- Construction Service Provider (18%)
- Electrical/Mechanical Service Provider (10%)
- Design Service Provider (8%)
- Fire & Security Service Protection (9%)

WORLDBEX SEMINARS

➤ Another WORLDBEX staple, the Worldbex Seminars are CPD- accredited seminars for architects, engineers, interior designers and other peers from the industry. The topics range from the latest trends in the building and construction design aspect to the current issues the urban community faces that needs to be addressed.

WORLDBEX Seminars 2018
 March 15 - 17
 SMX Convention Center Pasay, Metro Manila

PACKAGE DEAL
 PHP 7,000 For 3 Days
 REGULAR RATE PHP 3,000/DAY*
 *inclusive of lunch and snack
 CPD Points Accredited

Thursday, March 15, 2018

 Engr. Bayani Y. Bueser (PHILIPPINES) "Global Safety Issues"	 Archt. Ian Milne (HONGKONG) "Sustainable Casino Design Using the Widus Integrated Resort Project In Clark As Case Study"
 Engr. Ernesto S. de Castro PhD (PHILIPPINES) "BIM in Project Management"	 Archt. Jose Pedro "Bong" C. Recto (PHILIPPINES) "Architecture Rocks"

Friday, March 16, 2018

 Archt. Cathy S. Saldaña (PHILIPPINES) "For Design, Build & Real Estate: Retail, Hospitality, Industrial, Logistics"	 IDr. Ma. Carlota D. Hilvano, m.s. PIID (PHILIPPINES) "Interior Design For Golden Years"
 Archt. Azim A. Aziz (MALAYSIA) "Sustainable Design in the Tropics A Malaysian Experience"	 IDr. Lilia C. de Jesus (PHILIPPINES) "Sustainable Design For A More Inclusive & Democratic Interior Design In The Philippines"

Saturday, March 17, 2018

 Engr. Abner V. Pahilanga (PHILIPPINES) "Fire Suppression Operation & Maintenance"	 Archt. Raymond Hoe (SINGAPORE) "Sustainability & Smart Design: Reflections on User-centered Learning Environments"
 Archt. Susan C. Aquino-Ong, PhD (PHILIPPINES) "Majestic Ancient Trees on Earth, Open Green Spaces & Greenways Create Resilient Communities Landscape"	 Engr. Eugene F. Araullo (PHILIPPINES) "Considerations For The Adoption Of RE Technology in The Philippines"



...The multitudes of exhibitors and visitors from all over the Philippines and around the globe who are expected to converge for this annual grand and revolutionary event affirm our bright prospects for the Philippine property and construction industry..."

Noel M. Carino
 National President
 Chamber of Real Estate and Builders Association (CREBA)



EVENT HIGHLIGHTS

PROJÉTO MANILA

2018

©WORLD BEX

- A highlight of WORLDBEX that caters to the most promising market of the construction and design industry – the students. Yearly, students will be asked to create a design unique to them to address the current issues and/or concerns of the urban community.



BAM HOUSE: A Disaster Resilient Housing Design

This house strategy was designed for the Philippine context. The project attempts to create a 5.00 x 5.00 m (main module) single unit that is strong enough to withstand an earthquake and a 5 meter high floor. The proposal derived from bahay-kubo that utilizes local bamboos such as giant bamboo, bolo and kawayang-tinik.

EVENT HIGHLIGHTS

WORLDBEX LAB

2018

WORLDBEX

➤ This features the most outstanding innovative products of the various WORLDBEX exhibitors. At this year's WORLDBEX Lab, visitors were blown away with the state-of-the-art technologies that will change the way we build and live. The WORLDBEX Lab encourages industry players to uphold the spirit of boldness and fearless creativity.



"...Your very successful holding of exhibit for more than two (2) decades now with attracted hundreds of both local and international exhibitors is a genuine manifestations of the trust and confident of various organization and partners in the construction industry..."

Engr. Abner V. Pahilanga
President
Philippine Society
of Plumbing
Engineers (PSPE)

EVENT HIGHLIGHTS

CITY OF TOMORROW

2018

- To give everyone an inspiring glimpse into tomorrow, WORLDBEX invited various influential architects to come up with their own take on the future of metro structures – a collaborative project between the pioneers and mavericks of Philippine architecture. Brought together, these renditions form the “City of Tomorrow”, an exhibit of a scale model metropolis envisioned as tomorrow’s urban landscape.



“Being in this event is very engaging and enlightening most especially for us in the construction industry.”

Arch. Conrad T.
Onglao
C.T. Onglao
Architect’s Inc.

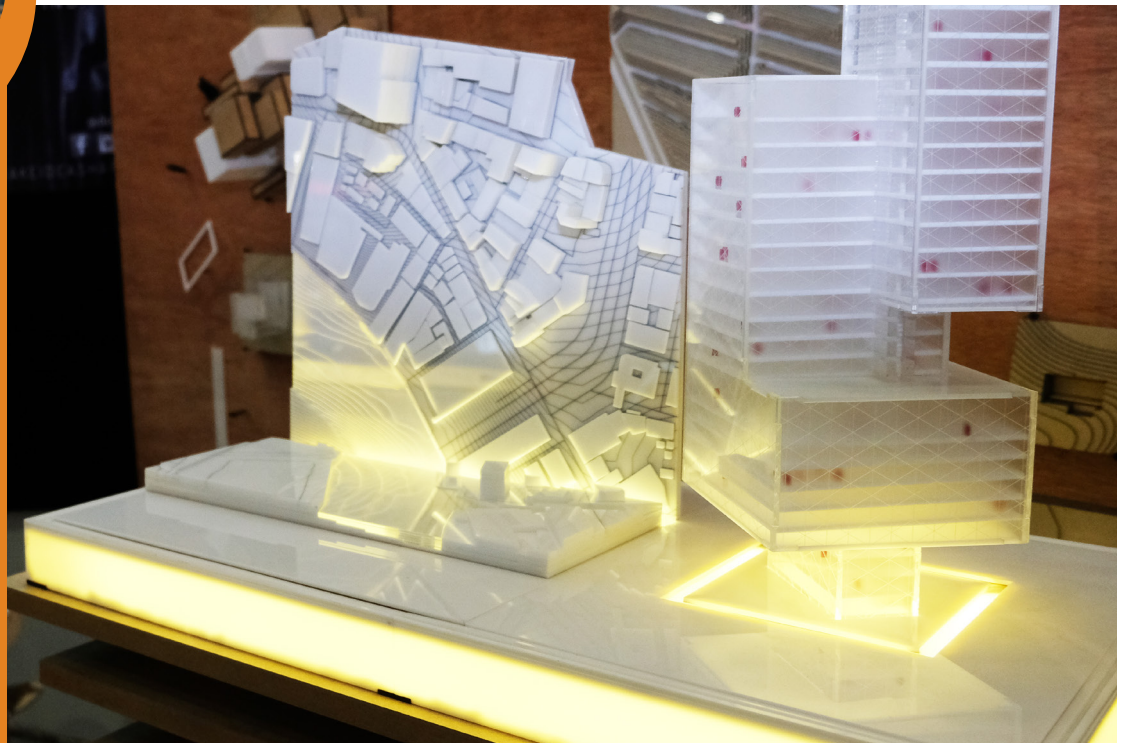

ARCHITECTS' GALLERY

- At WORLDBEX 2018, the spotlights will be turned on a handful of industry icons who will each be showcasing their insights into the future of construction and design as can be expected at this year's Architects Gallery. This houses unique design perspectives and insights to the latest trends by the industry's most influential practitioners under one roof. It features the top emerging infrastructure trends for the future. future.



"...We would like to thank the organizers for always inviting us to be part of this event that brings the different construction and design companies and industries altogether. It is really overwhelming and honored to be one of the sponsors of this event..."

Joanna Dela Cuesta
Firefly LED

INTERIOR DESIGNERS' GALLERY

➤ A spotlight on Filipino Interior Designers who have been revolutionizing the industry with their expertise and artistry. Interior Designers' Gallery showcases interior spaces that are more aesthetically pleasing and functionally useful presented by local interior designers under the welfare of Philippine Institute of Interior Designers.



"....WORLD BEX have already united strong foundations by giving different business opportunities, build bolder perspectives by providing various option of products and services and now, shaping sustainable innovations by being the center of the latest trends in the construction and design industry. Congratulations and more power to you!..."

Johnny Hubilla
Chancellor
PIID - College of
Fellows



EVENT HIGHLIGHTS

ASSOCIATION PAVILLION

2018

WORLD BEX

➤ The gallery houses many professionals in the Architecture, Engineering and Interior Design field. It aims to unite these experts that is continuously making a difference in the building and construction industries.



"...The much-awaited world-class exposition that will bring about disruptive innovations in the building and construction industry for the moment and the years to come is within our grasp again! Once again, we would like to congratulate WORLD BEX SERVICES INTERNATIONAL for every milestone you have reached this far!..."

Stephen Wong
Former President
Philippine
Association of
Electrical Industries,
Inc. (PAEII)



EVENT HIGHLIGHTS

INTERNATIONAL PAVILIONS

2018

WORLD BEX

- Bound to be the biggest convergence of the industry's most influential players, WORLDBEX 2018 hosted 18 participating countries including Malaysia, USA, Indonesia, Australia, Turkey, Germany, Iran and Japan in its bid to strengthen the ties between the local and international sector. Thus, the WORLDBEX International Pavilion offered a series of booths that showcase the products and services by the various international companies.



EMBASSY PAVILION

- The pavilion is a series of booths which caters the embassy partners of the event. The presence of the partner embassies of the event strengthens the relationship between the local and international



WORLD BEX MINICON

➤ - A WORLD BEX original, the Worldbex Mini Convention is a one-day seminar of some of its supporting associations for the year happening alongside the exposition at the SMX Convention Center meeting rooms 7-8-9. Some mini-cons being held are exclusive to members only of the association while some others are either on an FOC basis or with minimal fee and open to the public. Some seminars conducted are CPD-accredited with the initiative of the association, hence a good platform for the peers in the industry to stack up on their CPD points. the Philippines (LACISAP).



DELAXX COMPETITION

➤ The Design Excellence of Landscape, Architecture, Exhibit and Exposition (DELAXX) Competition, wherein young landscape architecture students and professional contended among each other as they transform the outdoor lawns of the venue into works of landscape art. The DELAXX Competition is co-presented with the Philippine Association of Landscape Architects (PALA) and Landscape Contractors and Industry Specialists Association of the Philippines (LACISAP).



"...Throughout the years, Worldbex and PALA's mutual partnership has elevated the practice of Filipino landscape architecture, establishing prolific partnerships between professionals, clients, and industry partners..."

L.Ar. Jose Antonio Bimbao
Philippine Association of Landscape Architects (PALA)

EVENT HIGHLIGHTS

2018

TRUCK PAVILION

- Located at the West Wing area of World Trade Center Metro Manila, this event highlight displays the latest and various trucks offered by the WORLDBEX exhibitors.



BUSINESS MATCHING

- This activity provides B2B opportunities to local and foreign investors. The said Business Matching Services assist participating companies and trade show visitors who are seeking to establish business connections and investment opportunities with ease and accuracy.



WORLDBEX APP

➤ An integrated event mobile software solution that connects the exhibitors and visitors. Through the app, exhibitors can maximize their exposures plus they get to interact with their visitors and collect their information. Visitors can also meet and connect with new and existing business leads.

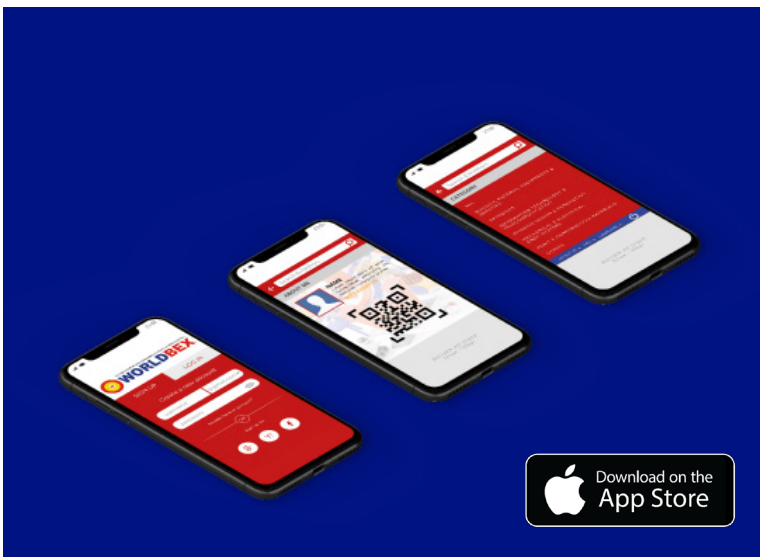

PHP 64, 553, 940

TOTAL MEDIA VALUES

China defends Rodry in UN psych test remark

DOJ chief: Kerwin, Lim not yet off the hook

WORLDWBEX BREAKS RECORD AT 23

WORLDWBEX BREAKS RECORD AT 23

WORLDWBEX 2018 leads at the forefront of global expansion

The Manila Bulletin Anniversary Special

118th Anniversary

WORLDWBEX BREAKS RECORD AT 23

Innovation and sustainability collide at WORLDWBEX Seminars 2018

Pacsafe's anti-theft bags now available at SM Seaside



"...I am very impressed by this year's WORLDWBEX, very huge and very well attended. This is a good opportunity for the shareholders of the industry for all those who are part of the industry, for all those who are affected by the industry, for all those who had something to do with the industry..."

Mike Enriquez
Brand Ambassador
Jea Steel Industries

HOW TO USE

CPD POINTS ACCREDITED

MONTHLY FORECAST

TRIVIA

WSI HOLDS ADVANCE BOOKING DAY

WORLDWBEX 2018

CPD POINTS ACCREDITED

WORLDWBEX 2018 is a must-attend event for all industry professionals. It offers a unique opportunity to network, learn, and showcase your products and services. Don't miss out on this exciting event!

WORLDWBEX 2018 is a must-attend event for all industry professionals. It offers a unique opportunity to network, learn, and showcase your products and services. Don't miss out on this exciting event!

WORLDWBEX 2018 is a must-attend event for all industry professionals. It offers a unique opportunity to network, learn, and showcase your products and services. Don't miss out on this exciting event!

MEDIA EXPOSURE

2018

WORLD BEX

TV AND RADIO GUESTINGS



MEDIA EXPOSURE

2018

WORLD BEX

OOH ADVERTISEMENTS





THE 24TH PHILIPPINE WORLD BUILDING AND CONSTRUCTION EXPOSITION

WORLDBEX

2018



MARCH 13 - 17, 2019

10:00 AM - 8:00 PM

**WORLD TRADE CENTER METRO MANILA
SMX CONVENTION CENTER MANILA**

WORLDBEX SERVICES INTERNATIONAL

+632 656 9239 www.worldbex.com info.worldbex@gmail.com